

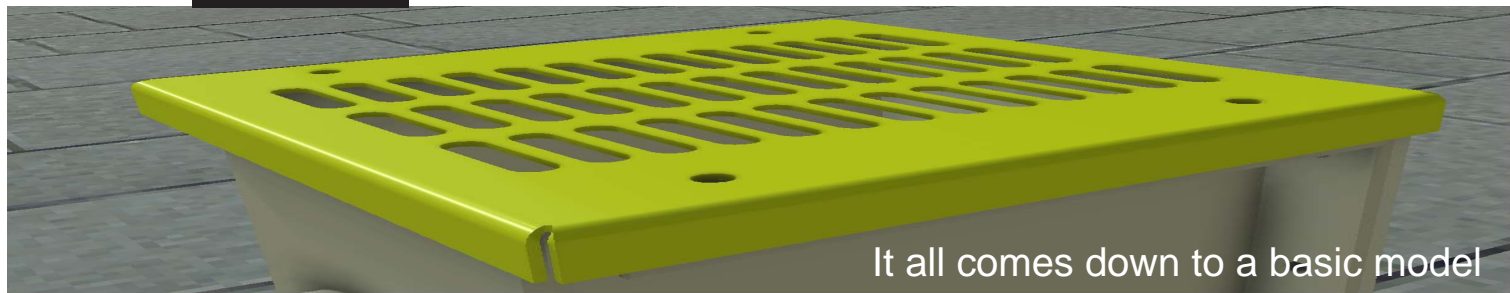

# Sheet metal parametric templates

for Inventor



It all comes down to a basic model



## SELECT THE MODEL

You can call the model to be created in any environment.

The menu is always available in every work environment.

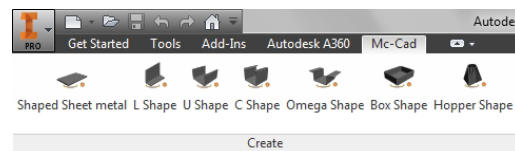

## ENTER THE DIMENSIONS

Enter the dimensions via wizard interface and tendon selection.

Automatically reads the rules / styles sheets User.

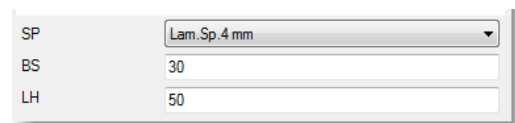

## AUTOMATIC DESCRIPTION

The user can configure the creation of the description for each model.

Any descriptions of size, will be updated automatically by changing the size of the part.

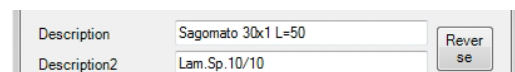

## SELECT MATERIAL

Direct selection of the material through the drop down list  
Direct access to its library of materials.

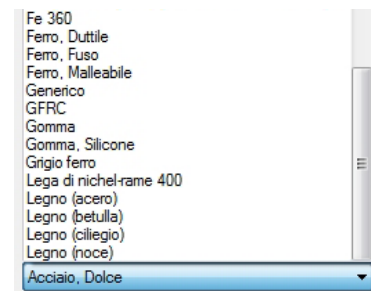

## SELECT PROCESS

Direct selection of four types of treatment / process.

Each button is configurable and you can:

- assign a color to the "graphic" Inventor
- create one or more custom iProperties
- fill in the values of iProperty created

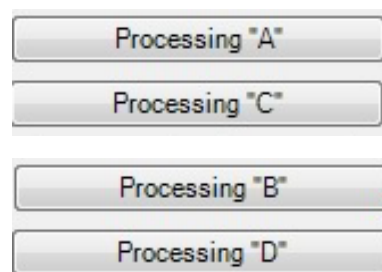



# Sheet metal parametric templates

for Inventor

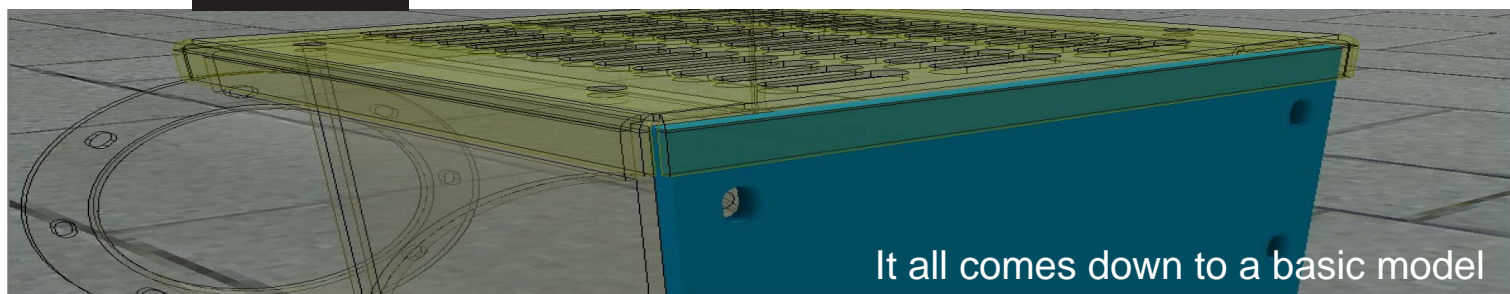

## CHANGE THE MODEL

Is possible change the template by the magic wand of self-change.

It calls up the menu of the detail to change automatically.

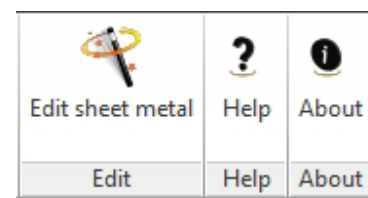

## INSTANT UPDATE

Through the Apply button, you will get the update now, to get comfortable in an assembly preview of the final result.

- Changing dimensions
- Updating descriptions
- Updating the color
- Updating custom iProperties
- Update 2D title block and BOM

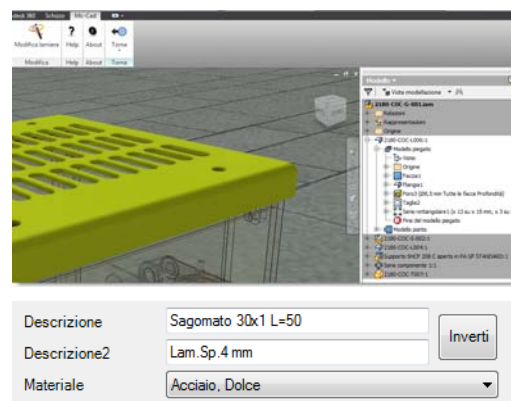

## COMPATIBILITY

Changes can also be made by traditional methods, dimensional changes through sketches, Features; changes colors, materials.

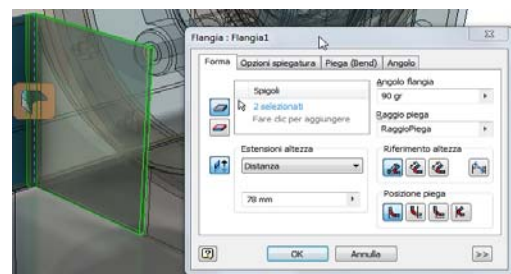

## ACTIVE INTERFACE

Possibility of maintaining the active interface, select other Inventor commands and add / edit processing, edit the size of the base through the interface and see immediate results

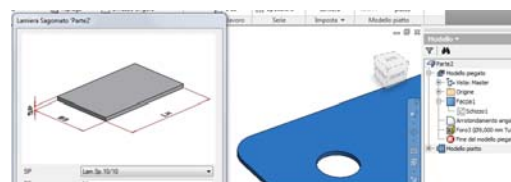



# Sheet metal parametric templates

for Inventor

**mc-cad**

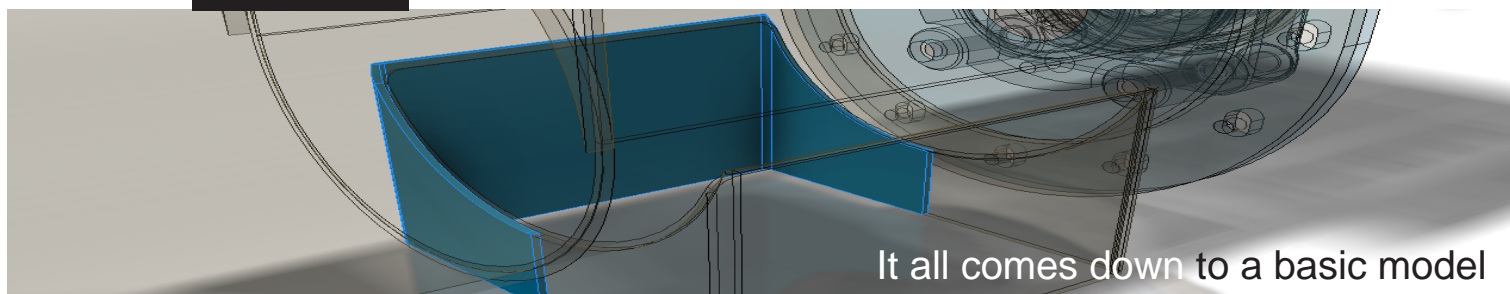

It all comes down to a basic model



## INTUITIVE INTERFACE

Simple interfaces for data input.  
Installation in Italian or English

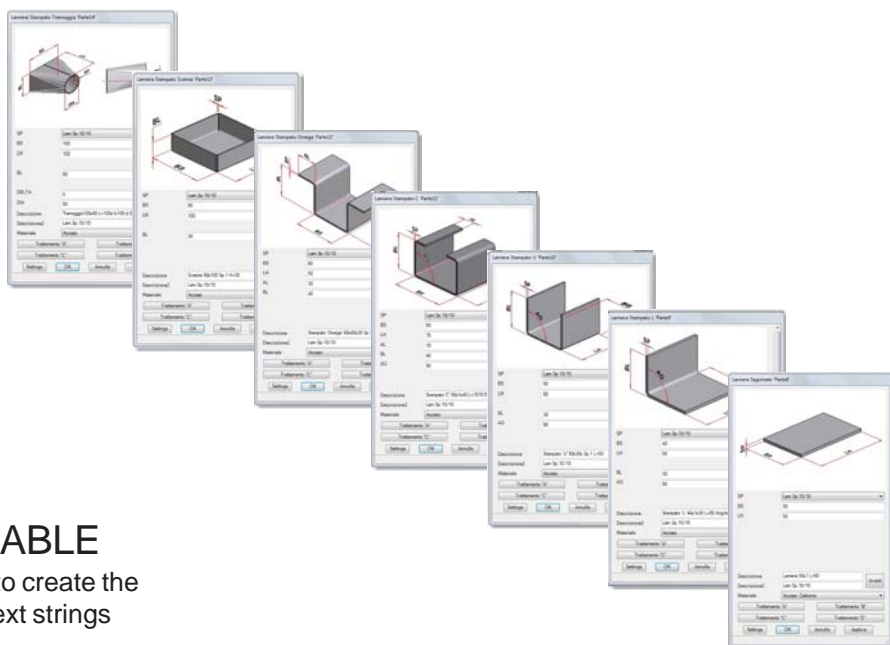

## DESCRIPTION CONFIGURABLE

For each model, you can configure a rule to create the description based on the combination of text strings "fixed" and dimensional variables

## CONFIGURABLE PROCESS

Every one of the 4 keys is configurable and you can:

- assign a color to the "graphic" Inventor
- create one or more custom iProperties
- fill in the values of iProperty created

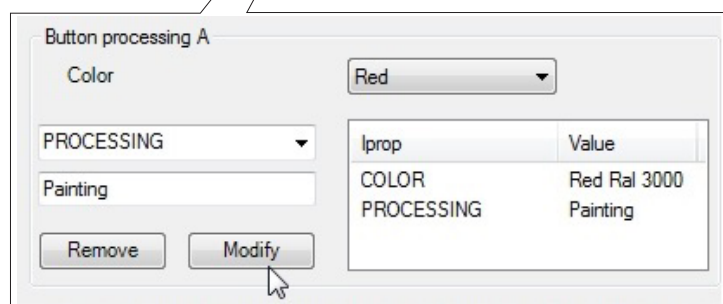
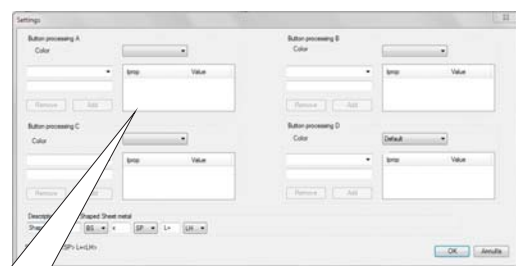





# Sheet metal parametric templates

for Inventor

